

SMART WIRELESS  
**MEAT THERMOMETER**

**USER  
MANUAL**

FOR

**HERQS008**



# Get to know the device



Wireless frequency range: 2400MHz-2483.5MHz  
Average current: 2.4V/22uA  
Max wireless transmission power: 2.5dbm

# Screen introduction



 Please check the probe battery on the herQs APP

## Display description

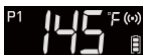

Probe 1  
Internal temperature



Probe 1  
Ambient temperature



Probe 1  
Probe has no signal



Probe 1  
Ambient temperature  
is lower than 50°C/122°F

## Download the APP

Search the keyword '**herQs**' in Appstore or Google Play,  
or scan the following QR code with your phone.  
Download and install it for free.

Make sure your phone meets  
the requirements:

iOS devices running version 12.0 or later

Android devices running version  
5.0 or later

with blue-tooth 4.0 module.



**APP DOWNLOAD**

# How to use

## STEP 1 Power ON/OFF

- ① Take out the probe (any one or all)

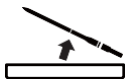

- ② Press and hold the button for more than 1.5 seconds when it is in OFF mode, it will be powered on. And the LCD display will show 'ON'.  
• if you do the same when it is in ON mode, it will be powered OFF.

*\*If the repeater is turned on and the probe is not taken out, the repeater will automatically shut down soon.*

### STEP 1-1

Take out the probe



### STEP 1-2

Press&hold 1.5 seconds to Power ON/OFF

## STEP 2 Activate device and pair with your phone

- 1 Switch on your device and keep the blue-tooth switch of your phone on.
- 2 **Activate** • Launch the '*herOs*' app.  
**device:** • Enable mobile phone permissions  
• Follow the instructions in the app to activate the device
- 3 **Pairing:** i: Choose the product you have on app  
ii: Press the Button (on the right of the device)
- 4 Connected successfully.

*Once device is paired with your phone, you don't need to do it again, unless you change to other phones.*

## Enjoy your barbecue time

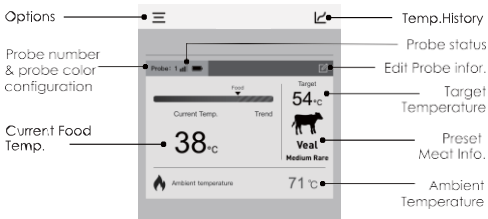

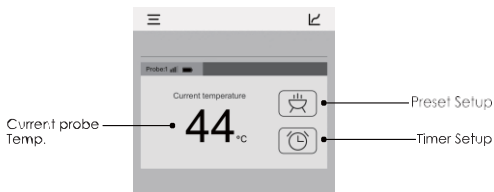

*The user interface of the app may be changed when upgraded. Please follow the instructions in the app.*

## WARNING

The heat resistance varies in different components of the probe, DO NOT put the probe needle part directly in fire flame. And probes are NOT dishwasher safe.

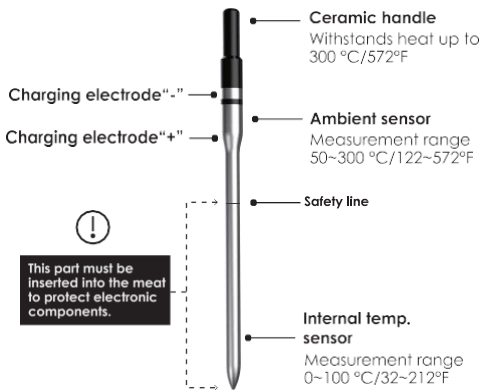

*Attention: Temp. Probe above for reference only, subject to the actual probes.*

# Replace new probe and pair with repeater

**STEP 1** Take out the probe from the dock

**STEP 2** Press & hold the **button** for 11.5 seconds  
(Allowed in both power ON state or power OFF state)

If it is turned on, it will be turned off first, and automatically enter the pairing state.

If it is turned off, it will be turned on first, and automatically enter the pairing state.

**STEP 3** Put the probe into the dock and pair for 30 seconds

P1 and P2 icons on the screen flash alternately for **30 seconds**.

**STEP 4** Paired successfully

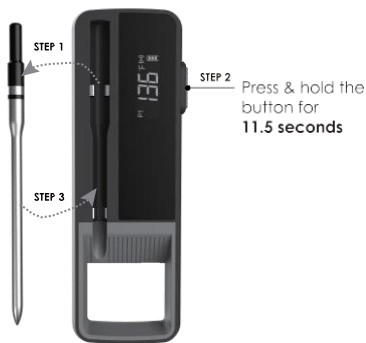

**Operation is subject to the following two conditions:**

(1) This probe may not cause interference; (2) This probe must accept an interference, including interference that may cause undesired operation of this device.

App Store is a service mark of Apple Inc.

Google Play is a service mark of Google Inc.

## **FCC Caution.**

This device complies with part 15 of the FCC Rules. Operation is subject to the following two conditions:(1) This device may not cause harmful interference, and (2) this device must accept any interference received, including interference that may cause undesired operation.

### **15.21 Information to user.**

Any Changes or modifications not expressly approved by the party responsible for compliance could void the user's authority to operate the equipment.

### **15.105 Information to the user.**

**Note:** This equipment has been tested and found to comply with the limits for a Class B digital device, pursuant to part 15 of the FCC Rules. These limits are designed to provide reasonable protection against harmful interference in a residential installation. This equipment generates uses and can radiate radio frequency energy and, if not installed and used in accordance with the instructions, may cause harmful interference to radio communications. However, there is no guarantee that interference will not occur in a particular installation. If this equipment does cause harmful interference to radio or television reception, which can be determined by turning the equipment off and on, the user is encouraged to try to correct the interference by one or more of the following measures:

- Reorient or relocate the receiving antenna.
- Increase the separation between the equipment and receiver.
- Connect the equipment into an outlet on a circuit different from that to which the receiver is connected.
- Consult the dealer or an experienced radio/TV technician for help.

This equipment complies with FCC radiation exposure limits set forth for an uncontrolled environment. This equipment should be installed and operated with minimum distance 20cm between the radiator & your body.